

LPA-CS5-15

High Flow Undersink Filter System



SPECIFICATIONS

Service Flow Rate	1.7GPM (6.43L/min)
Rated Capacity	17,000 Gallons (64,645L)
Operation Temperature	4~38°C (39~100°F)
Pressure Requirements	10~100 psi (0.7~6.9bar)
Inlet / Outlet Connection	3/8"
Electrical Connection	None required
Dimension	Overall : 3.7" 16.9" Cartridge : Ø3.3" 15.7"
Weight	0.8kg
Claim	Chlorine, Taste and Odor, Particulate, Scale Inhibitor

FEATURES · BENEFITS

- Phosphate can prevent to make scale in boiler or heater (phosphate)
- 5micron pore size CTO Block
- Extrusion carbon production method provides stable quality and
- Pre-shield Technology can prevent early clogging and keep the lifespan.
- Replacement method is easy quick-change.

APPLICATION



Water Station



ICE



Cold Beverage



Drinking Fountain



Food Service

PART INCLUDED

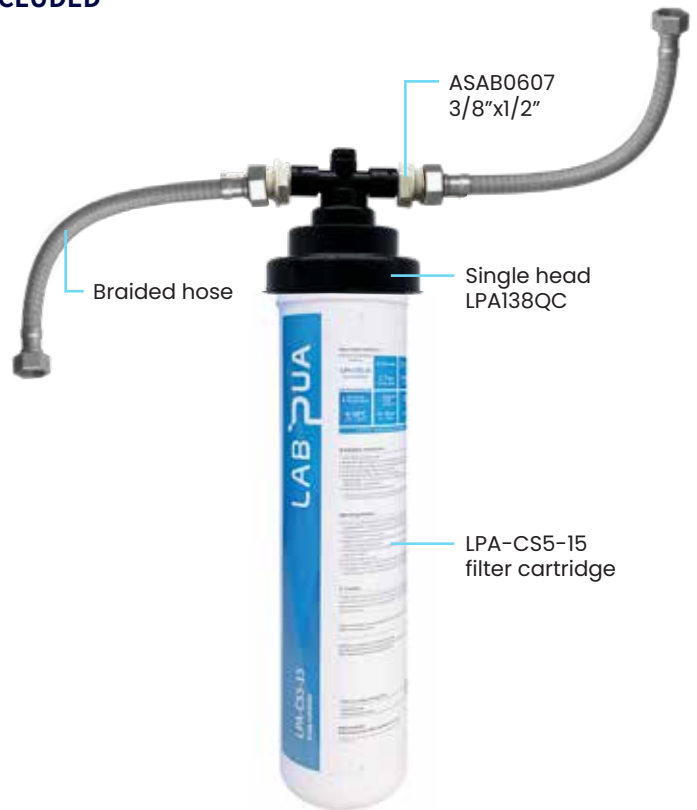

System tested and certified by NSF International against NSF/ANSI Standards 42 & 401 in System Model LPA-CS5-15 for reduction claims specified on the performance data sheet.



INSTALLATION INSTRUCTIONS

1. Turn off main tap water
2. Rotate the old cartridge counter clockwise 1/4 turn and pull it out.
3. Insert the new cartridge into the filter head and rotate clockwise 1/4 turn.
4. Place the cartridge to the vertical position.
5. Turn on the main tap water and check for leaks. If leaks occurs, repeat step 1.2.3.4.

If leaks persist, discontinue use and call your supporting dealer.

6. Flush filter for 10 minutes before use or until water runs clear.

* The system and installation shall comply with applicable state and local regulations.

* Spent adsorption media will not be regenerated and used.

1. Turn off main tap water

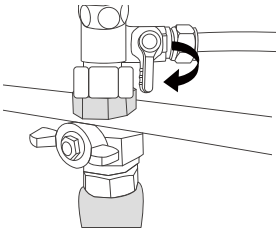

2. Rotate the old cartridge counter clockwise 1/4 turn and pull in out.

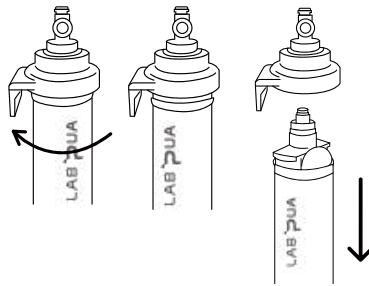

3. Insert the new cartridge into the filter head and rotate clockwise 1/4 turn.

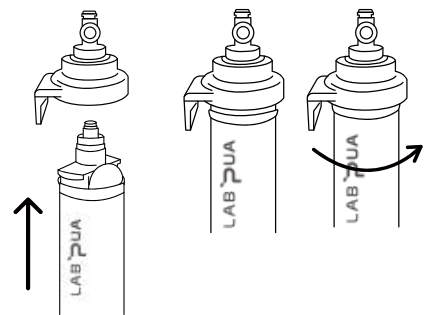

4. Place the cartridge to the vertical position.

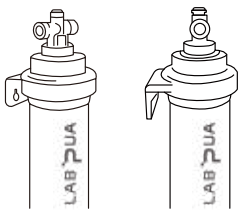

5. Turn on the main tap water and check for leaks. If leaks occurs, repeat step 1.2.3.4. If leaks persist, discontinue use and call your supporting dealer.

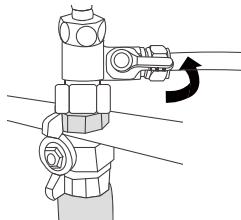

6. Flush filter for 10 minutes before use or until water runs clear.

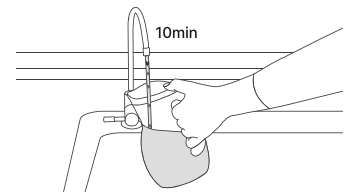

PERFORMANCE DATA SHEET

Substance	Influent Challenge Concentration	Average Reduction	Reduction requirement	Max Permissible Product water Concentration
Chlorine Taste and Odor	2.0mg/L ± 10%	96.8%	≥ 50%	N/A
Nominal Particulate Class 3 (>5um to <15um)	At least 10,000 particles/mL	> 99.8%	≥ 85%	N/A

Testing Conditions : temperature 20±2°C ; pH 7.4 ; Flow rate 2.1GPM, Pressure 60psi